

ITEM	PART NUMBER	DESCRIPTION	QTY
1	SM200-0021	PANEL, BOTTOM	1
2	SM400-0022	PANEL, SIDE	2
3	SM300-0023-01	PANEL, FRONT MOD	1
4	SM300-0024	PANEL, REAR	1
5	SM400-0025-02	PLATE, PROBE MODIFIED	1
6	SM400-0026	COVER, PLEXI	1
7	SM200-0027	HINGE	2
8	SM200-0028	BLOCK, PIVOT LATCH	1
9	SM200-0029	LATCH, CAPTIVATING	2
10	SM200-0030	ARM, PIVOT	2
11	SM200-0031-01	BLOCK, HINGE	2
12	SM200-0032-01	BLOCK, LATCH PIN	2
13	SM200-0033	HANDLE	1
14	SM200-0204-01	PIN, PUSH w/1/4-20 NUTS	14
15	SM200-0209	BLOCK, SPACER	2
16	SM200-0214	LATCH	1
17	P0003	SPRING (LC-032C-12MW)	2
18	P0006	HINGE, CARLSON 702 LEFT	1
19	P0007	HINGE, CARLSON 702 RIGHT	1
20	P0020	HINGE, CARLSON 703 LEFT	1
21	P0021	HINGE, CARLSON 703 RIGHT	1
22	P0034	BUMPON	4
23	P0044	HANDLE, SIDE	2
24	P0045	SPRING, PLUNGER	1
25	P0056	SPRING	4
26	SM200-0526	BUSHING, STEP	4
27	SM400-0870	PLATE, STRIPPER	1

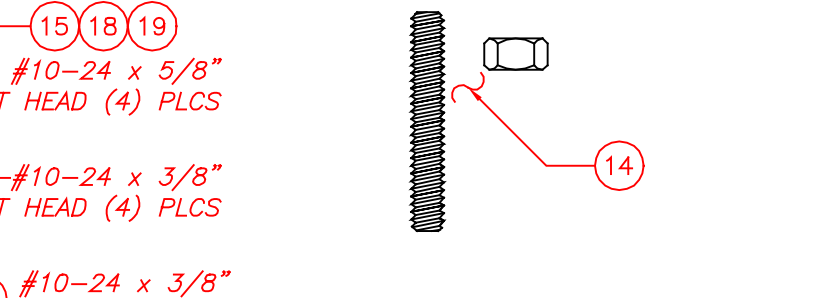

ORDERING INSTRUCTIONS

KIT	PAN SIZES										OPTIONS CODE			
	5	6	7	8	9	10	11	12	13	14				
ASM-1001-														
KIT, NO LATCH, NO OPTIONS, 4" BARE BOARD & PAN, NO UHA					2	5	P				A	W		R1
BARE BD & PAN W/LATCH NO UHA					4	0	P							
ESD BARE BD/PAN W/LATCH NO UHA														
UPPER HEAD ASSEMBLY														
UPPER HEAD ASSEMBLY ESD														
PAN ASSEMBLY ONLY NO LATCH														
PAN ASSEMBLY ONLY W/LATCH														
COMPLETE KIT W/LATCH														
KIT W/LATCH ESD PLATES														
KIT W/LATCH & STRIPPER PLATE														
KIT W/LATCH/STRIPPER W/ESD PLATES														

OPTION CODE
A= GAS SHOCKS
W=MICROSWITCH
R1=.25 RISER BLOCKS
R3=.50 RISER BLOCKS
R5=.75 RISER BLOCKS
R7=1.00 RISER BLOCKS

QTY	ASSEMBLY NUMBER	ECN	REV.	DATE	REVISION	BY	DATE	APVD
1	ASM-1001-XT		C	8/22/95	UPDATED DWG	MN	11/04	
TOLERANCES UNLESS OTHERWISE SPECIFIED.								
INCHES			ANGULAR			APPROVALS		
.X ± .02			±1'			DESIGNED		
.XX ± .01						M NACCI		
.XXX ± .005						DRAWN		
FRACTIONAL = STOCK SIZE						D DeLAJARRO		
DE-BURR ALL EDGES .020 MAX.						6/1/01		
CHECKED						RELEASED		
						M NACCI		
						8/22/95		
						SCALE		
						1:1		
						DWG NO		
						ASM-1001-XT		
						SHEET		
						1 of 1		
						REV.		
						C		

SEMCO PROPRIETARY

MT-101 TEST FIXTURE W/ STRIPPER PLATE